

1 FIRST FLOOR PLAN
A2.2 1/4" = 1'-0"

PERMIT SET 2-1-06

REV. #	REV. NO.	DATE	REVISIONS
1	1	2-1-06	ADDENDUM 1

DANIEL BALL & ASSOCIATES
 ARCHITECTURE & PLANNING
 5513 TWIN HICKLES ROAD, SUITE 216
 GREENBELT, MD 20886
 PHONE: (410) 751-5888 FAX: (410) 751-5889

GASPAR RESIDENCE - MONTGOMERY COUNTY, MD
 FOR

PROJECT MANAGER	JL
APPROVED BY	
DRAWN BY	KH/KVS
SCALE	1/4" = 1'-0"
DATE	2-1-06
SHEET NO.	A2.2

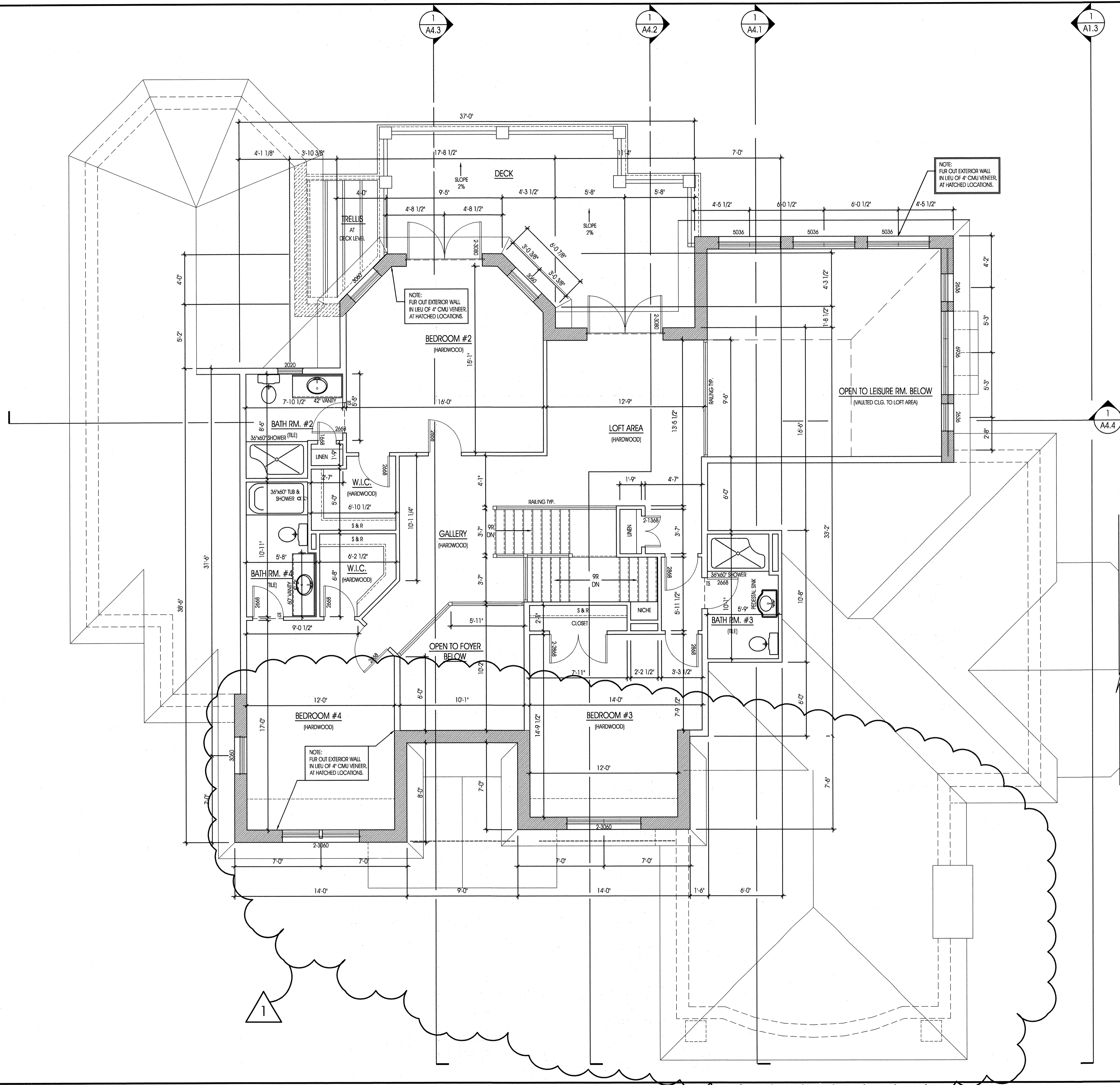

1
A2.3 SECOND FLOOR PLAN
1/4" = 1'-0"

REV. #	REV. NO.	DATE	REVISIONS
1	1	3-2-06	ADDENDUM 1

DANIEL BALL & ASSOCIATES
 ARCHITECTURE & PLANNING
 5513 TWIN LAKES ROAD, SUITE 216
 PINEVILLE, MD 21083
 PHONE: (410) 715-5808 FAX: (410) 715-0969

GASPAR RESIDENCE - MONTGOMERY COUNTY, MD
 FOR

PROJECT MANAGER	JL
APPROVED BY	
DRAWN BY	KH/KVS
SCALE	1/4" = 1'-0"
DATE	2-1-06
SHEET NO.	A2.3

PERMIT SET 2-1-06